

MANIFOLD 2 FLOW & RETURN PIPEWORK DROP BELOW TO SERVE MANIFOLD IN GARAGE

Flow & Return Pipework To be Lagged in Condensed areas.

BUILDERS HOLE: 450mm (W) x 75mm (H)

BUILDERS HOLE: 100mm (W) x 75mm (H)

BUILDERS HOLE: 200mm (W) x 75mm (H)

GROUND FLOOR

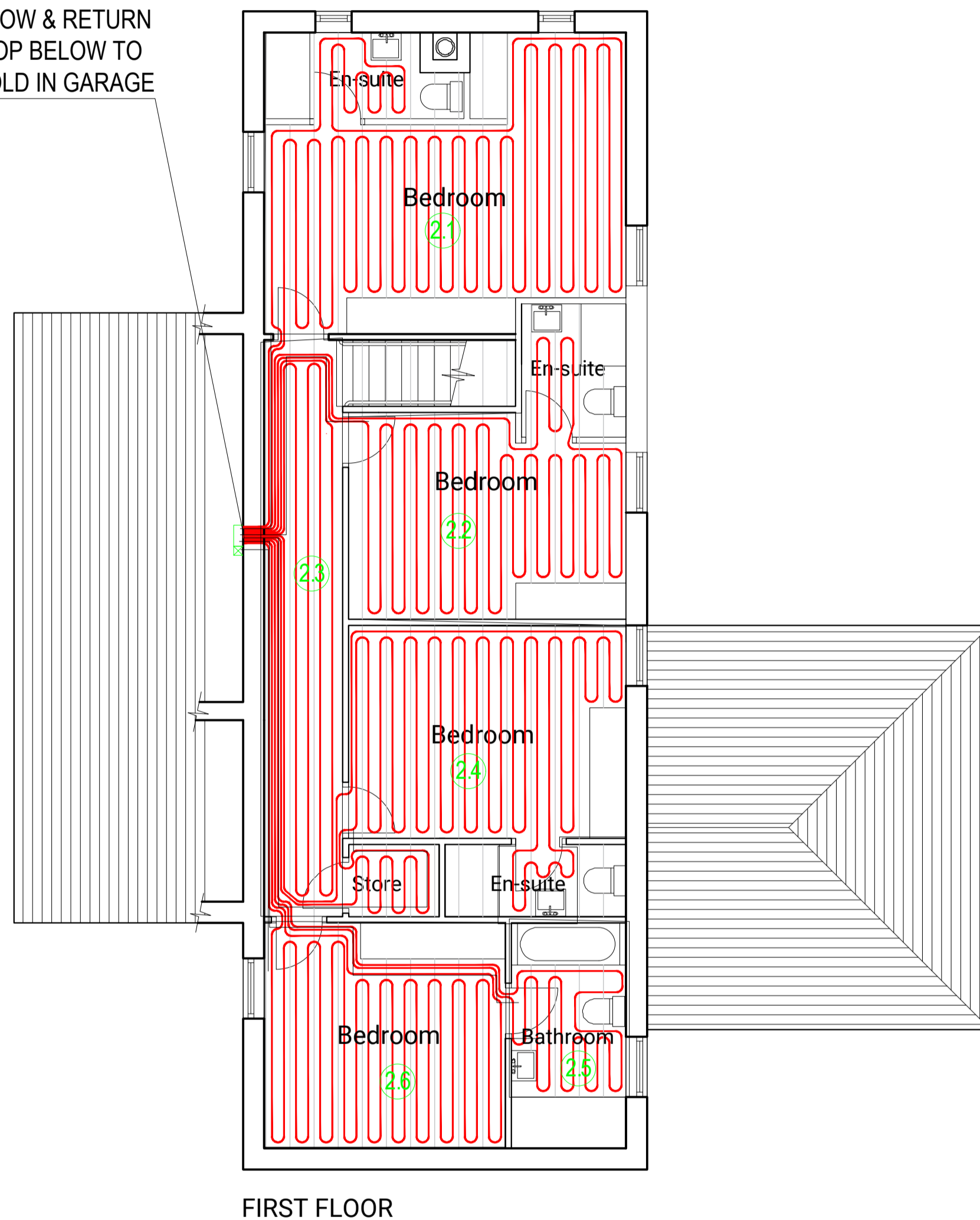

FIRST FLOOR

Manifold 1

Circuit No.	1.1	1.2	1.3	1.4	1.5	1.6	1.7	1.8	1.9	1.10
Pipe Length(m)	20m	92m	86m	45m	100m	88m	92m	45m	75m	55m
Pipe Spacing (mm)	200mm	200mm	200mm	200mm	200mm	200mm	200mm	200mm	200mm	200mm
Pipe Size (mm)	16mm	16mm	16mm	16mm	16mm	16mm	16mm	16mm	16mm	16mm
Thermostat	T	T	T	T	T	T	T	T	T	T

Manifold Flow Rate: 0.25 l/s @ 21 kPa

Flow Rate To Manifold: 0.13 l/s @ Min 5 - Max 30 kPa

Manifold 2

Circuit No.	2.1	2.2	2.3	2.4	2.5	2.6
Pipe Length(m)	130m	100m	52m	120m	48m	86m
Pipe Spacing (mm)	200mm	200mm	200mm	200mm	200mm	200mm
Pipe Size (mm)	16mm	16mm	16mm	16mm	16mm	16mm
Thermostat	T	T	T	T	T	T

Manifold Flow Rate: 0.12 l/s @ 21 kPa

Flow Rate To Manifold: 0.07 l/s @ Min 5 - Max 30 kPa

PROPOSED MANIFOLD SET

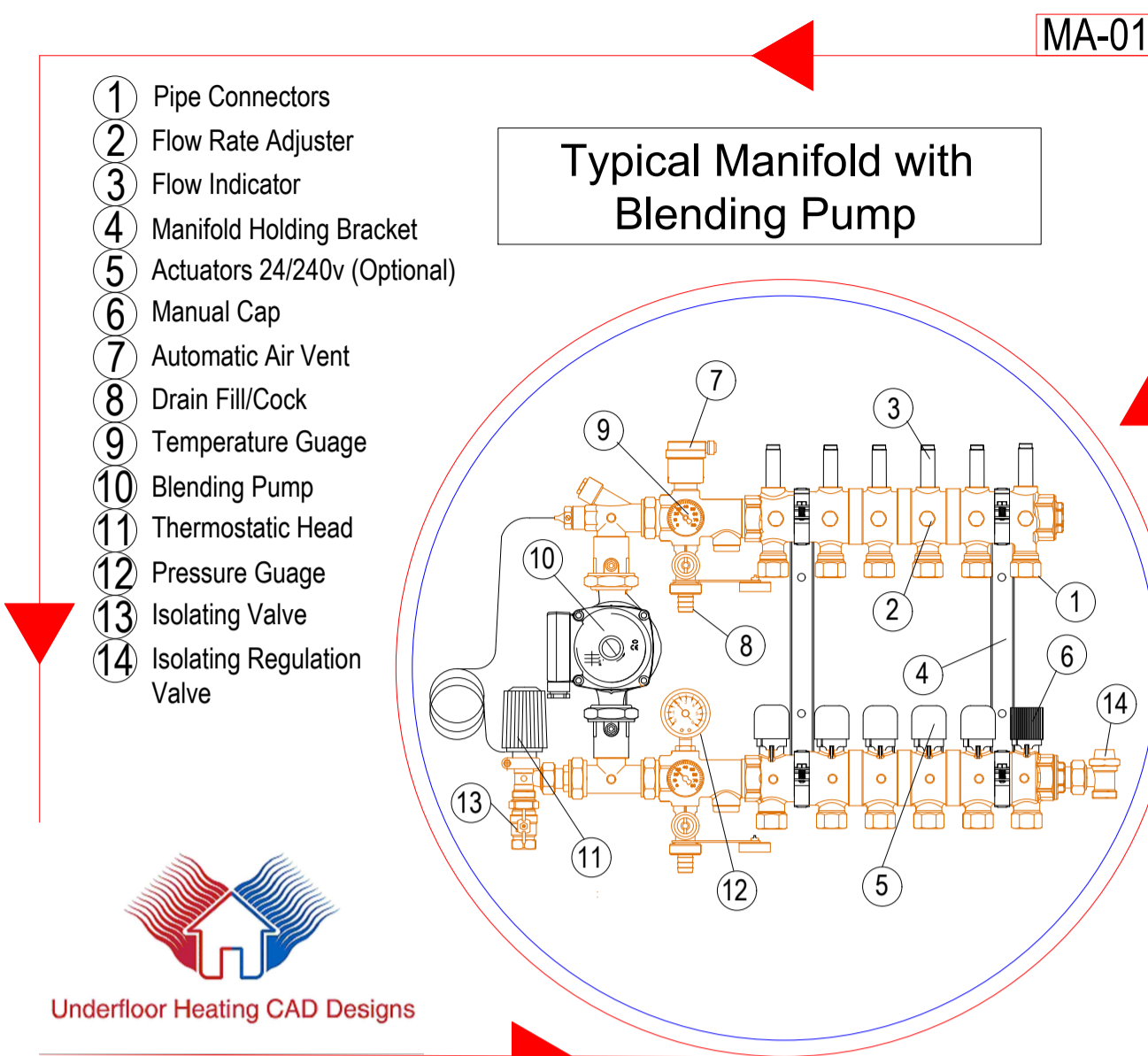

PROPOSED GROUND FLOOR BUILD UP

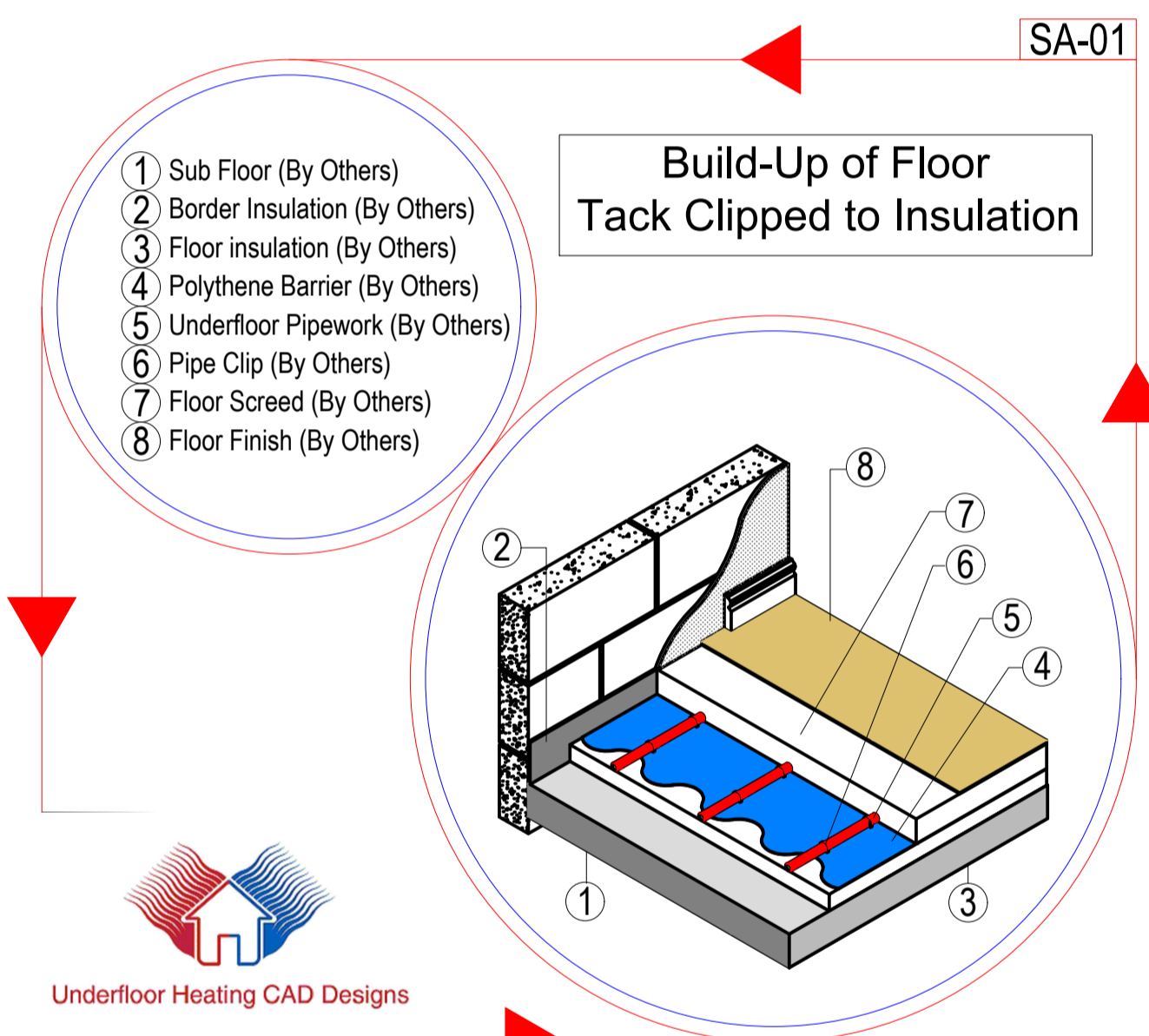

PROPOSED FIRST FLOOR BUILD UP

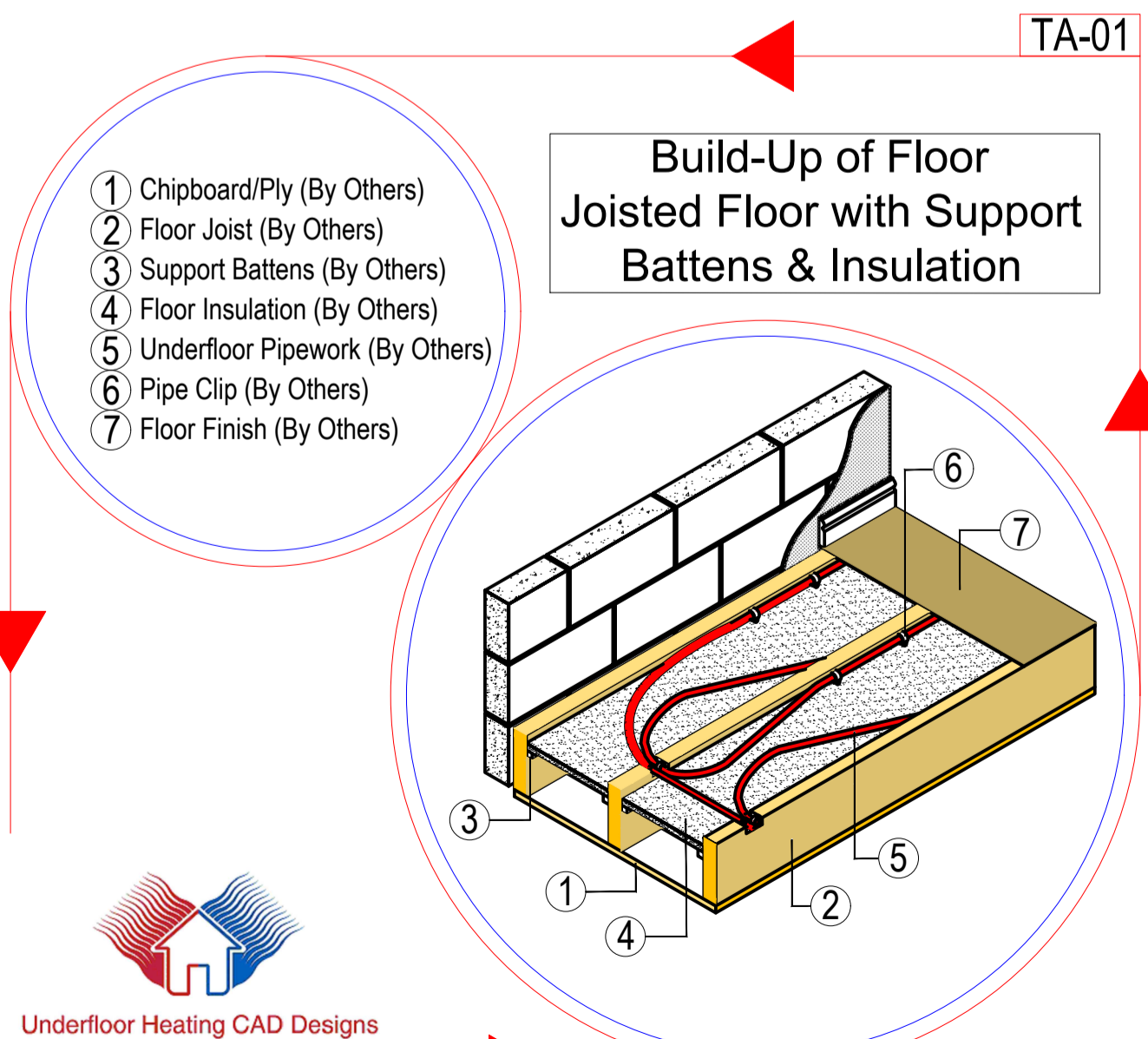

Notes to be Read - before Approval of Drawings

Controls Information
1: All Thermostats and Sensors positions shown on the drawing are to be checked by the client and Electrician at Approval stages, until then they will be positioned indicatively.

Underfloor Heating
2: Underfloor Heating shall not be installed under any furniture i.e. cupboards, kitchen units, built in wardrobes unless its co-ordinated on site prior to installation.

Floor Coverings
3: All Floor coverings and carpets must be suitable for use with Underfloor Heating, please check with provider before buying. Standard Carpets Underlay's should have a Tog rating 10r less.

Screed Information
4: Screed is to be laid on the recommendation of the Screeder, no unwanted force such as Pedestrian crossing, access of large equipment or vehicles must not be used unless the screed has been covered and protected, to stop any damages occurring.

Electrical Information
5: All conduits or floor boxes or any other electrical equipment in the floor should be highlighted on the drawings at Approval stages and co-ordinated on site prior to installation. All cables should be within conduit and not in direct contact with Insulation.

Structural Requirements
6: The structural engineer must check that the floor section shown is suitable for the applied application and the dead loads shown on the floor.

Underfloor Heating Drawing Information
7: The drawing shows underfloor heating being laid indicative and can change once its been co-ordinated on site and laid by a competent person, once laid the drawing will be updated to suit installation on As-Fit Drawings.



A APPROVAL

Rev	Amendment Details	Date
A-1	FOR APPROVAL -	12.05.20

PROJECT TITLE				
The Shires - Clifton				
DESCRIPTION				
PROPOSED UNDERFLOOR HEATING LAYOUT TO GROUND & FIRST FLOOR				
DRAWING No	No OF DRAWINGS	SCALE	PAPER SIZE	REVISION
C00-01	1 of 1	1:75	A1	A-1